

TT.25 END CAP Line end

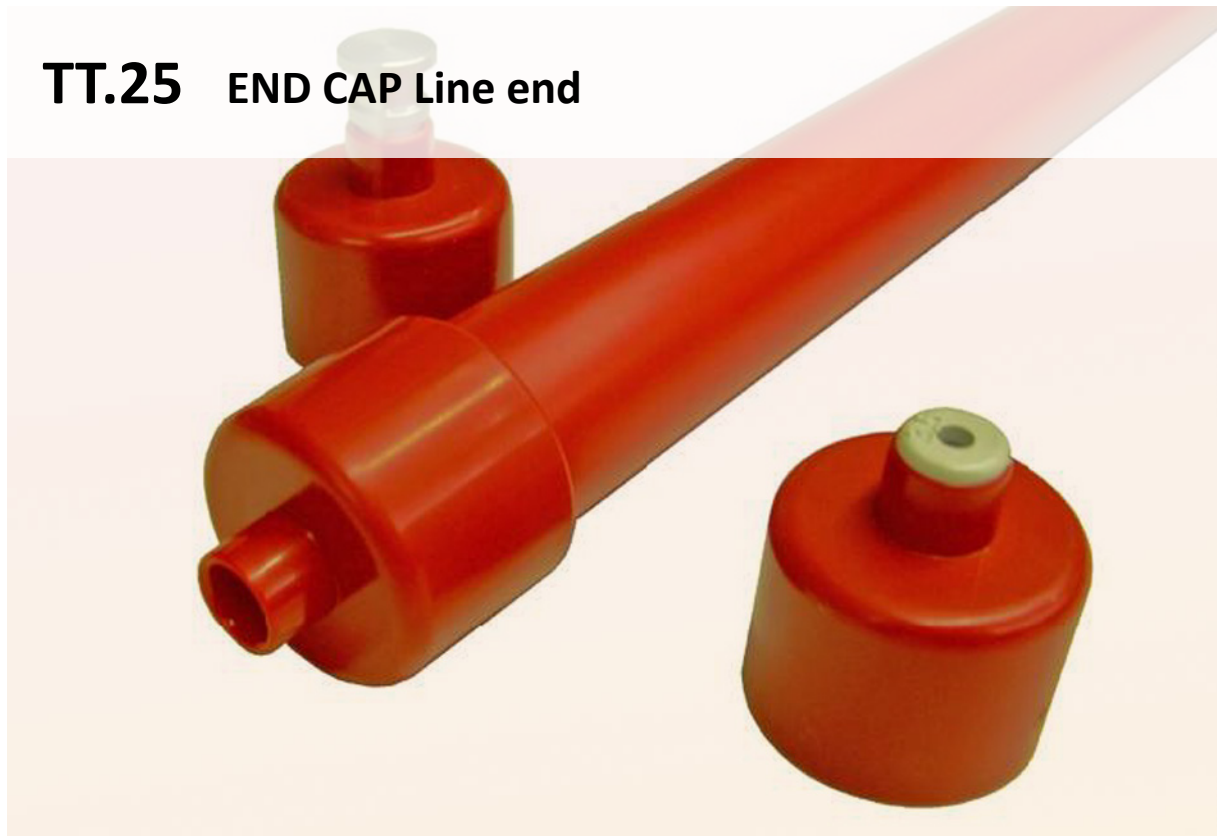

MODELS:

- TT.25** ABS Red
- TT.25 B** ABS White
- TT.25 RF** ABS Fireproof Red

SIZE:

Quotes in Millimeters

- D = Ø 30,6
- d = Ø 25
- d¹ = 8
- L = 13

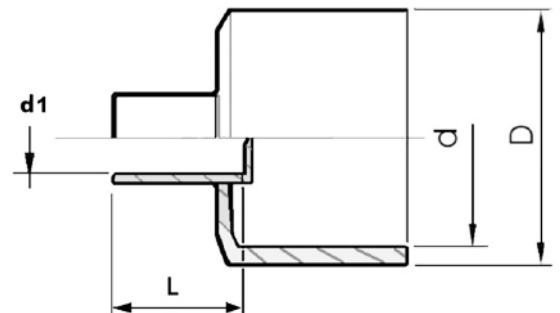

- Supplied completely closed for generic use.
- Its design allows to drill the inside shank end of 8 mm so that it can be used together with the Cleaning CAP Ref TL (hermetic).
- It can also be used as a Sampling Point at the end of a line or adaptable to the Ø 8 mm capillary
- Presentation: **5 units** bag

MATERIAL:

ABS (Acrylonitrile-Butadiene-Styrene)
Robust polymere with physic features for optimum strength to expansion and impact, hard resistance, high longevity, high resisting to temperatures bellow 0°.

ABS is a Halogen-free thermoplastic.

Maximum temperatures of use. -35° to 60°

END CAP	SECTION	ASD SYSTEMS
	DATE	MARCH 2015
Line end	REVISED	J. VALLS
	REF.	TT.25